

CUSTOMER APPROVAL SHEET

CUSTOMER :

CUSTOMER'S DWG NO :

CUSTOMER'S ITEM :

OUR DWG No :

OUR ITEM : RH Core Series

QUANTITY : PCS

DATE : 2017/12/22

SPECIFICATION

	“ ✓ ”	CUSTOMER'S SIGNATURE	NOTE
FULL APPROVAL			
CONDITIONAL APPROVED			
REJECTED			

DRAWN BY	CHECKED BY	APPROVED BY

Head office

聯磁企業股份有限公司

EROCORE Enterprise Co Ltd

(235) 16F., No.700, Jhongjheng Rd., Jhonghe City, Taipei Country, Taiwan(R.O.C.)

Tel: 886-2-82278908

Fax: 886-2-82278907

Web site: www.core.com.tw

EMI Cores / RH type

.Features

Employ High-Performance ferrites with superior frequency characteristic.
Compact and high performance. Easy installation.

.Application

Countermeasures against radiated emissions, for full compliance with FCC regulations and VCCI.
Improvement of noise immunity of personal computers, microcomputers, peripheral and relative devices.

.Product Identification



1



2



3

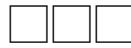

4



5

Series name	Type Code	Outer Diameter		Height		Inner Diameter	
A8	H	016	1.6	050	5	008	0.8
		024	2.4	025	2.5	013	1.3
		025	2.5	030	3	008	0.8
		028	2.8	037	3.7	016	1.6

.Shapes

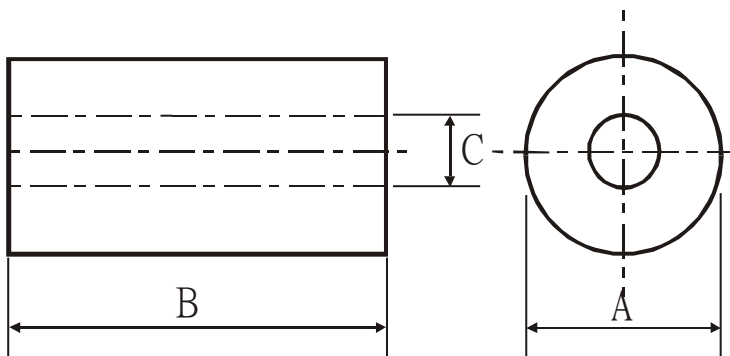

.Dimensions & Characteristics

Unit : mm

Part No.	A (mm)	B (mm)	C (mm)	Impedance (Ω) min.	
				25 MHz	100 MHz
A8H016050008	1.6 ± 0.15	5 ± 0.3	0.8 ± 0.1		33
A8H025030008	2.5 ± 0.15	3 ± 0.2	0.8 ± 0.15	20	30
A8H025030010	2.5 ± 0.15	3 ± 0.2	1 ± 0.15	10	30
A8H030035012	3 ± 0.3	3.5 ± 0.3	1.2 ± 0.2	15	45
A8H035008017	3.5 ± 0.2	0.8 ± 0.15	$1.7 +0.4 / -0$	5	20
A8H035012015	3.5 ± 0.2	1.2 ± 0.25	$1.5 +0.3 / -0$	5	20
A8H035012018	3.5 ± 0.2	1.25 ± 0.2	1.8 ± 0.2	6	20
A8H035015017	3.5 ± 0.3	1.7 ± 0.3	1.5 ± 0.3		20
A8H035020013	3.5 ± 0.15	2 ± 0.2	1.3 ± 0.1	10	25
A8H035020016	3.5 ± 0.3	2 ± 0.2	1.6 ± 0.2	10	30

EMI Cores / RH type
.Dimensions & Characteristics

Unit : mm

Part No.	A (mm)	B (mm)	C (mm)	Impedance (Ω) min.	
				25 MHz	100 MHz
A8H035020017	3.5 ± 0.3	2 ± 0.2	1.7 ± 0.3		20
A8H035020018	3.5 ± 0.2	2 ± 0.2	1.8 ± 0.2	10	30
A8H035025016	3.5 ± 0.3	2.5 ± 0.2	1.6 ± 0.2		25
A8H035060009	3.5 ± 0.15	6 ± 0.3	0.9 ± 0.1	40	70
A8H035030012	3.5 ± 0.2	3 ± 0.2	1.2 ± 0.15		30
A8H035030013	3.5 ± 0.2	3 ± 0.2	1.3 ± 0.1	15	30
A8H035030015	3.5 ± 0.2	3 ± 0.3	1.5 ± 0.2	15	25
A8H035030016	3.5 ± 0.3	3 ± 0.4	1.65 ± 0.3	15	25
A8H035030017	3.5 ± 0.15	3 ± 0.2	1.7 ± 0.15	10	25
A8H035030018	3.5 ± 0.3	3 ± 0.4	1.8 ± 0.3		20
A8H035032016	3.5 ± 0.2	3.25 ± 0.15	1.6 ± 0.15	15	30
A8H035035012	3.5 ± 0.15	3.5 ± 0.25	1.2 ± 0.15	20	50
A8H035035018	3.5 ± 0.15	3.5 ± 0.2	1.8 ± 0.15	15	29
A8H035040012	3.5 ± 0.3	4 ± 0.3	1.2 ± 0.2	25	40
A8H035040013	3.5 ± 0.15	4 ± 0.3	1.3 ± 0.15	20	40
A8H035040020	3.5 ± 0.2	4 ± 0.3	2 ± 0.2	10	25
A8H035045012	3.5 ± 0.4	4.5 ± 0.4	1.2 ± 0.3	20	35
A8H035045015	3.5 ± 0.2	4.5 ± 0.2	1.5 ± 0.15	15	35
A8H035050012	3.5 ± 0.3	5 ± 0.3	1.2 ± 0.2	35	60
A8H035050013	3.5 ± 0.15	5 ± 0.3	1.3 ± 0.15	20	40
A8H035050015	3.5 ± 0.15	5 ± 0.3	1.5 ± 0.15	20	45
A8H035050018	3.5 ± 0.15	5 ± 0.3	1.8 ± 0.15	10	35
A8H035060012	3.5 ± 0.15	6 ± 0.25	1.2 ± 0.15	35	60
A8H035060015	3.5 ± 0.15	6 ± 0.3	1.5 ± 0.15	20	40
A8H035060020	3.5 ± 0.2	6 ± 0.3	2 ± 0.2	15	30
A8H040030020	4 ± 0.2	3 ± 0.2	2 ± 0.2	15	25
A8H040050015	4 ± 0.2	5 ± 0.3	1.5 ± 0.15	20	35
A8H040050016	4 ± 0.3	5 ± 0.3	1.6 ± 0.2	25	60
A8H040050020	4 ± 0.3	5 ± 0.3	2 ± 0.3	20	40
A8H040060022	4 ± 0.2	6 ± 0.3	2.2 ± 0.15	20	40
A8H040250022	4 ± 0.2	25 ± 0.6	2.2 ± 0.15	90	120
A8H041032016	4.1 ± 0.3	3.2 ± 0.3	1.6 ± 0.2	15	35
A8H041040016	4.1 ± 0.2	4 ± 0.2	1.6 ± 0.15		30

EMI Cores / RH type
.Dimensions & Characteristics

Unit : mm

Part No.	A (mm)	B (mm)	C (mm)	Impedance (Ω) min.	
				25 MHz	100 MHz
A8H041050016	4.1 \pm 0.3	5 \pm 0.3	1.6 \pm 0.2	25	45
A8H041060020	4.1 \pm 0.2	6 \pm 0.3	2 \pm 0.15	20	30
A8H045030025	4.5 \pm 0.25	3 \pm 0.3	2.5 \pm 0.2	15	45
A8H045035015	4.5 \pm 0.2	3.5 \pm 0.25	1.5 \pm 0.15	15	30
A8H045070025	4.5 \pm 0.2	7 \pm 0.3	2.5 \pm 0.15	35	65
A8H048038025	4.8 \pm 0.4	3.8 \pm 0.3	2.5 \pm 0.2	15	50
A8H050030023	5 \pm 0.25	3 \pm 0.2	2.3 \pm 0.2	10	29
A8H050050025	5 \pm 0.3	5 \pm 0.3	2.5 \pm 0.2	20	50
A8H050060015	5 \pm 0.2	6 \pm 0.3	1.5 \pm 0.15		48
A8H050060024	5 \pm 0.3	6 \pm 0.3	2.4 \pm 0.15		30
A8H050100010	5 \pm 0.2	10 \pm 0.4	1 \pm 0.15	35	55
A8H050180021	5 \pm 0.2	18 \pm 0.5	2.15 \pm 0.15	80	120
A8H050100022	5.08 \pm 0.2	10 \pm 0.4	2.29 \pm 0.15	40	65
A8H060250020	6 \pm 0.2	25 \pm 0.6	2 \pm 0.15	135	200
A8H063254029	6.35 \pm 0.2	25.4 \pm 0.6	2.95 \pm 0.15	108	200
A8H063127032	6.35 \pm 0.2	12.7 \pm 0.4	3.2 \pm 0.2	55	102
A8H065100040	6.5 \pm 0.2	10 \pm 0.4	4 \pm 0.2	20	40
A8H065100043	6.5 \pm 0.25	10 \pm 0.4	4.3 \pm 0.2	20	45
A8H065100045	6.5 \pm 0.2	10 \pm 0.4	4.5 \pm 0.2	15	35
A8H075075023	7.52 \pm 0.2	7.54 \pm 0.3	2.39 \pm 0.15	30	60
A8H076047031	7.65 \pm 0.3	4.78 \pm 0.2	3.18 \pm 0.2	20	45
A8H078130040	7.8 \pm 0.2	13 \pm 0.4	4 \pm 0.2	45	80
A8H078125050	7.8 \pm 0.2	12.5 \pm 0.4	5 \pm 0.25	30	60
A8H080250036	8 \pm 0.3	25 \pm 0.6	3.6 \pm 0.2	65	115
A8H080150053	8 \pm 0.2	15 \pm 0.4	5.3 \pm 0.25	40	80
A8H090160050	9 \pm 0.3	16 \pm 0.4	5 \pm 0.25	50	80
A8H090160050	9.05 \pm 0.3	16.2 \pm 0.4	4.7 \pm 0.2	60	110
A8H095095048	9.5 \pm 0.25	9.5 \pm 0.3	4.8 \pm 0.3		45
A8H095102030	9.5 \pm 0.3	10.2 \pm 0.4	3.05 \pm 0.2	50	90
A8H095250047	9.5 \pm 0.4	25 \pm 0.6	4.7 \pm 0.2	73	135
A8H095195055	9.5 \pm 0.2	19.5 \pm 0.6	5.5 \pm 0.3	50	100
A8H095254047	9.5 \pm 0.3	25.4 \pm 0.6	4.75 \pm 0.2	75	135
A8H095145048	9.5 \pm 0.3	14.5 \pm 0.4	4.8 \pm 0.2	53	75

EMI Cores / RH type
.Dimensions & Characteristics

Unit : mm

Part No.	A (mm)	B (mm)	C (mm)	Impedance (Ω) min.	
				25 MHz	100 MHz
A8H095145050	9.5 ± 0.3	14.5 ± 0.4	5 ± 0.25	50	100
A8H095095052	9.5 ± 0.3	9.5 ± 0.4	5.2 ± 0.25	35	65
A8H096104050	9.65 ± 0.3	10.4 ± 0.4	5.02 ± 0.25	30	60
A8H097102038	9.7 ± 0.3	10.2 ± 0.4	3.8 ± 0.2	60	100
A8H098115010	9.8 ± 0.2	11.5 ± 0.3	1 ± 0.15	120	200
A8H098157063	9.8 ± 0.3	15.7 ± 0.4	6.35 ± 0.3	45	65
A8H098135063	9.8 ± 0.3	13.5 ± 0.4	6.35 ± 0.25	30	60
A8H100195042	10 ± 0.35	19.5 ± 0.5	4.25 ± 0.3	80	120
A8H100250050	10 ± 0.3	25 ± 0.6	5 ± 0.25	125	160
A8H100250055	10 ± 0.3	25 ± 0.6	5.5 ± 0.25	90	160
A8H100140060	10 ± 0.3	14 ± 0.4	6 ± 0.3	35	75
A8H100062061	10 ± 0.3	6.2 ± 0.3	6.15 ± 0.3	45	85
A8H100200065	10 ± 0.4	20 ± 0.6	6.5 ± 0.25	40	90
A8H100100050	10 ± 0.3	10 ± 0.4	5 ± 0.3	30	60
A8H100100060	10 ± 0.3	10 ± 0.4	6 ± 0.3	25	60
A8H100100070	10 ± 0.3	10 ± 0.4	7 ± 0.3	20	40
A8H100075073	10 ± 0.3	7.5 ± 0.2	7.3 ± 0.2	13	28
A8H105200055	10.5 ± 0.3	20 ± 0.5	5.5 ± 0.25	65	120
A8H105200060	10.5 ± 0.4	20 ± 0.6	6 ± 0.3	50	90
A8H105200065	10.5 ± 0.3	20 ± 0.5	6.5 ± 0.3	40	80
A8H110200050	11 ± 0.3	20 ± 0.5	5 ± 0.25	80	140
A8H110250050	11 ± 0.3	25 ± 0.6	5 ± 0.25	115	180
A8H113120059	11.3 ± 0.3	12 ± 0.4	5.95 ± 0.25	40	70
A8H115200049	11.5 ± 0.5	20 ± 0.6	4.9 ± 0.25	100	200
A8H115250049	11.5 ± 0.3	25 ± 0.5	4.9 ± 0.25	85	120
A8H118150050	11.8 ± 0.3	15 ± 0.4	5 ± 0.3	40	80
A8H118150073	11.8 ± 0.3	15 ± 0.4	7.3 ± 0.3	40	75
A8H118150074	11.86 ± 0.3	15 ± 0.4	7.4 ± 0.3	35	75
A8H120130080	12 ± 0.3	13 ± 0.4	8 ± 0.3	35	75
A8H120150073	12 ± 0.4	15 ± 0.4	7.3 ± 0.3	35	75
A8H120150085	12 ± 0.3	15 ± 0.4	8.5 ± 0.3	30	50
A8H120192037	12 ± 0.3	19.2 ± 0.6	3.7 ± 0.2	60	120
A8H120200056	12 ± 0.3	20 ± 0.5	5.6 ± 0.25	100	200

EMI Cores / RH type
4. Dimensions & Characteristics

Unit : mm

Part No.	A (mm)	B (mm)	C (mm)	Impedance (Ω) min.	
				25 MHz	100 MHz
A8H120200060	12 ± 0.3	20 ± 0.5	6 ± 0.3	60	110
A8H120200065	12 ± 0.4	20 ± 0.5	6.5 ± 0.25	60	100
A8H120228080	12 ± 0.3	22.8 ± 0.6	8 ± 0.25	40	80
A8H120230040	12 ± 0.3	23 ± 0.5	4 ± 0.2	160	230
A8H120235037	12 ± 0.3	23.5 ± 0.6	3.7 ± 0.2	95	160
A8H120250045	12 ± 0.3	25 ± 0.4	4.5 ± 0.2	125	204
A8H120250056	12 ± 0.4	25 ± 0.6	5.6 ± 0.3	80	120
A8H123127050	12.3 ± 0.3	12.7 ± 0.4	5 ± 0.25	60	120
A8H127127079	12.7 ± 0.3	12.7 ± 0.4	7.9 ± 0.3	30	60
A8H127150079	12.7 ± 0.5	15 ± 0.5	7.9 ± 0.4	25	60
A8H130127073	13 ± 0.4	12.7 ± 0.4	7.3 ± 0.2	30	60
A8H130180050	13 ± 0.3	18 ± 0.5	5 ± 0.25	50	100
A8H130200050	13 ± 0.3	20 ± 0.5	5 ± 0.25	90	140
A8H140150068	14 ± 0.4	15 ± 0.4	6.8 ± 0.3	65	120
A8H140150078	14 ± 0.4	15 ± 0.4	7.8 ± 0.3	35	70
A8H142127072	14.2 ± 0.4	12.7 ± 0.4	7.2 ± 0.3	40	60
A8H142150065	14.2 ± 0.4	15 ± 0.4	6.5 ± 0.3	50	90
A8H142150090	14.2 ± 0.4	15 ± 0.4	9 ± 0.3	50	100
A8H142200045	14.2 ± 0.4	20 ± 0.5	4.5 ± 0.3	100	170
A8H142235080	14.2 ± 0.4	23.5 ± 0.5	8 ± 0.3	65	135
A8H142285045	14.2 ± 0.4	28.5 ± 0.8	4.5 ± 0.3	120	280
A8H142285063	14.2 ± 0.4	28.5 ± 0.6	6.35 ± 0.6	100	190
A8H142285082	14.2 ± 0.4	28.5 ± 0.3	8.2 ± 0.3	80	170
A8H142360063	14.2 ± 0.4	36 ± 0.8	6.35 ± 0.6	150	280
A8H142285072	14.2 ± 0.4	28.5 ± 0.6	7.2 ± 0.3	130	210
A8H142285070	14.2 ± 0.4	28.5 ± 0.6	7 ± 0.3	100	120
A8H142285080	14.2 ± 0.4	28.5 ± 0.6	8 ± 0.3	60	150
A8H142285091	14.2 ± 0.4	28.5 ± 0.6	9.15 ± 0.3	100	170
A8H143233063	14.3 ± 0.4	23.3 ± 0.5	6.35 ± 0.3	100	180
A8H143285091	14.3 ± 0.4	28.5 ± 0.6	9.15 ± 0.3	75	120
A8H143285090	14.3 ± 0.4	28.5 ± 0.6	9 ± 0.3	75	120
A8H145080105	14.5 ± 0.4	8 ± 0.3	10 ± 0.4	18	45
A8H157285073	15.7 ± 0.4	28.5 ± 0.6	7.3 ± 0.3	90	180

EMI Cores / RH type
.Dimensions & Characteristics

Unit : mm

Part No.	A (mm)	B (mm)	C (mm)	Impedance (Ω) min.	
				25 MHz	100 MHz
A8H157285075	15.7 ± 0.4	28.5 ± 0.6	7.5 ± 0.3	90	180
A8H157285105	15.7 ± 0.4	28.5 ± 0.6	10.5 ± 0.3	60	100
A8H158285080	15.88 ± 0.4	28.5 ± 0.6	8 ± 0.3	100	160
A8H160160080	16 ± 0.4	16 ± 0.4	8 ± 0.3	55	110
A8H160170090	16 ± 0.4	17 ± 0.4	9 ± 0.3	60	80
A8H160280090	16 ± 0.4	28 ± 0.6	9 ± 0.3	80	150
A8H160280105	16 ± 0.4	28 ± 0.6	10.5 ± 0.3		100
A8H165160082	16.5 ± 0.4	16 ± 0.4	8.2 ± 0.2	50	165
A8H170254087	17.07 ± 0.4	25.4 ± 0.6	8.76 ± 0.3	90	130
A8H172285070	17.2 ± 0.4	28.5 ± 0.6	7 ± 0.3	140	230
A8H172280071	17.2 ± 0.4	28 ± 0.6	7.1 ± 0.3	120	180
A8H175127095	17.5 ± 0.5	12.7 ± 0.4	9.5 ± 0.3	50	150
A8H175285095	17.5 ± 0.4	28.5 ± 0.6	9.5 ± 0.3	85	145
A8H175285107	17.5 ± 0.5	28.5 ± 0.8	10.7 ± 0.3	70	120
A8H175285110	17.5 ± 0.5	28.5 ± 0.7	11 ± 0.4	80	165
A8H175350095	17.5 ± 0.4	35 ± 0.8	9.5 ± 0.3	120	200
A8H175240105	17.5 ± 0.4	24 ± 0.6	10.5 ± 0.4	85	130
A8H175285105	17.5 ± 0.4	28.5 ± 0.6	10.5 ± 0.4	60	120
A8H175285100	17.5 ± 0.4	28.5 ± 0.6	10 ± 0.4	100	240
A8H175285110	17.5 ± 0.4	28.5 ± 0.6	11 ± 0.4	80	130
A8H175285115	17.5 ± 0.5	28.5 ± 0.8	11.5 +0.2 / -0.6	60	110
A8H175285128	17.5 ± 0.5	28.5 ± 0.8	12.8 ± 0.4	40	80
A8H180180105	18 ± 0.5	18 ± 0.5	10.5 ± 0.3	45	90
A8H182282097	18.2 ± 0.5	28.2 ± 0.6	9.7 ± 0.3	104	192
A8H184120096	18.4 ± 0.4	12 ± 0.4	9.6 ± 0.3	40	60
A8H185285126	18.5 ± 0.5	28.5 ± 0.6	12.6 ± 0.5	50	80
A8H187282102	18.7 ± 0.5	28.2 ± 0.6	10.2 ± 0.4	70	130
A8H190100100	19 ± 0.5	10 ± 0.3	10 ± 0.3	39	73
A8H190290130	19 ± 0.5	29 ± 0.6	13 ± 0.4	60	110
A8H192286116	19.2 ± 0.5	28.6 ± 0.6	11.6 ± 0.4	76	118
A8H200280100	20 ± 0.5	28 ± 0.8	10 ± 0.3	95	150
A8H205290115	20.7 ± 0.6	28.5 ± 0.6	12 ± 0.4	80	130
A8H207285120	20.7 ± 0.6	28.5 ± 0.6	12 ± 0.4	85	160

EMI Cores / RH type
.Dimensions & Characteristics

Unit : mm

Part No.	A (mm)	B (mm)	C (mm)	Impedance (Ω) min.	
				25 MHz	100 MHz
A8H210300100	21 \pm 0.5	30 \pm 0.8	10 \pm 0.4	100	150
A8H220280140	22 \pm 0.6	28 \pm 0.8	14 \pm 0.5	60	120
A8H259285129	25.9 \pm 0.8	28.5 \pm 0.75	12.9 \pm 0.5		200
A8H259290123	25.9 \pm 0.6	29 \pm 0.6	12.3 \pm 0.4	90	180
A8H259290127	25.9 \pm 0.6	29 \pm 0.6	12.7 \pm 0.4	120	240
A8H260285130	26 \pm 0.6	28.5 \pm 0.6	13 \pm 0.4	116	180
A8H260285140	26 \pm 0.6	28.5 \pm 0.6	14 \pm 0.4	90	180
A8H270300100	27 \pm 0.5	30 \pm 0.9	10 \pm 0.3	95	150
A8H280280140	28 \pm 0.6	28 \pm 0.6	14 \pm 0.4	110	180
A8H280285160	28 \pm 0.6	28.5 \pm 0.6	16 \pm 0.4	110	220
A8H280285180	28 \pm 0.6	28.5 \pm 0.6	18 \pm 0.4	75	140
A8H283285138	28.3 \pm 0.7	28.5 \pm 0.5	13.8 \pm 0.5	135	240